

Instruction Manual Addendum
Model # MCS

Please take note that all pump units are tested at the factory prior to shipment and in most cases tested again by the manufacturer of the system that the pump is used on.

There is always a possibility that damage can occur during transit and if you feel that the pump unit was affected you should contact the system manufacturers for resolution.

Pump warranty covers “Defects” in material and workmanship and not normal wear, transit damages, over pressure of pump unit, water hammer, dry running, or corrosives and/or abrasive in pumpage or improper rotation of pump unit.

The mechanical seal in the pump unit is a “wear” part and as such has limited warranty. It is generally accepted in the industry that if the seal does not leak within the first couple of weeks of operation that there were no defects in material and workmanship of the mechanical seal supplied.

If you feel that the mechanical seal has a leak the following steps should be taken.

- First determine that the leak is actually from the seal. There is a “leak drain hole” located in the bottom rear side of the motor adapter (refer to picture and parts breakdown sheet enclosed). If there is no liquid coming from this hole, then the leak is not from the mechanical seal.
- If it is determined that the leak may be coming from the casing area, the casing bolts should be checked in the following manner.

[Secure screws with a right angle nutsetter set @ 65 LBS/in Torque. If screws were numbered 1-8, the proper tightening sequence is #1, #5, #3, #7, #2, #6, #8 and #4. In most cases this will put the proper tension on the “covering o-ring” and stop any leakage here.]

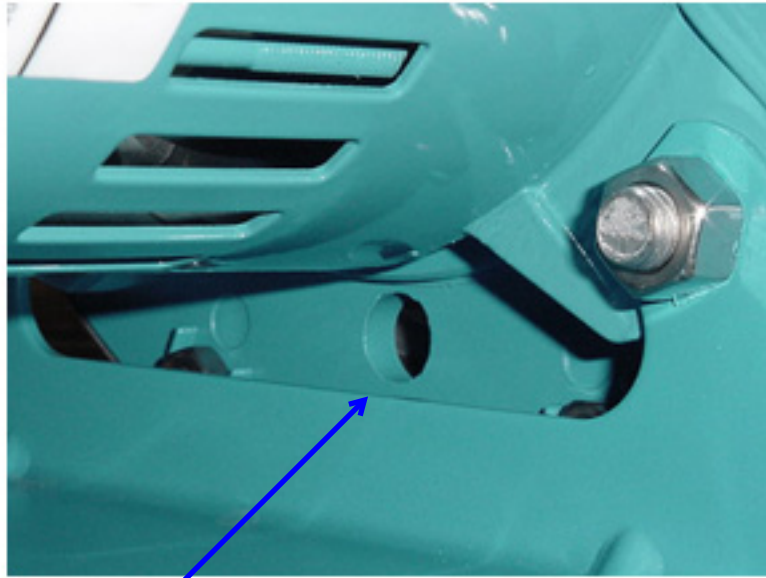

MECHANICAL SEAL DRAIN LEAK HOLE

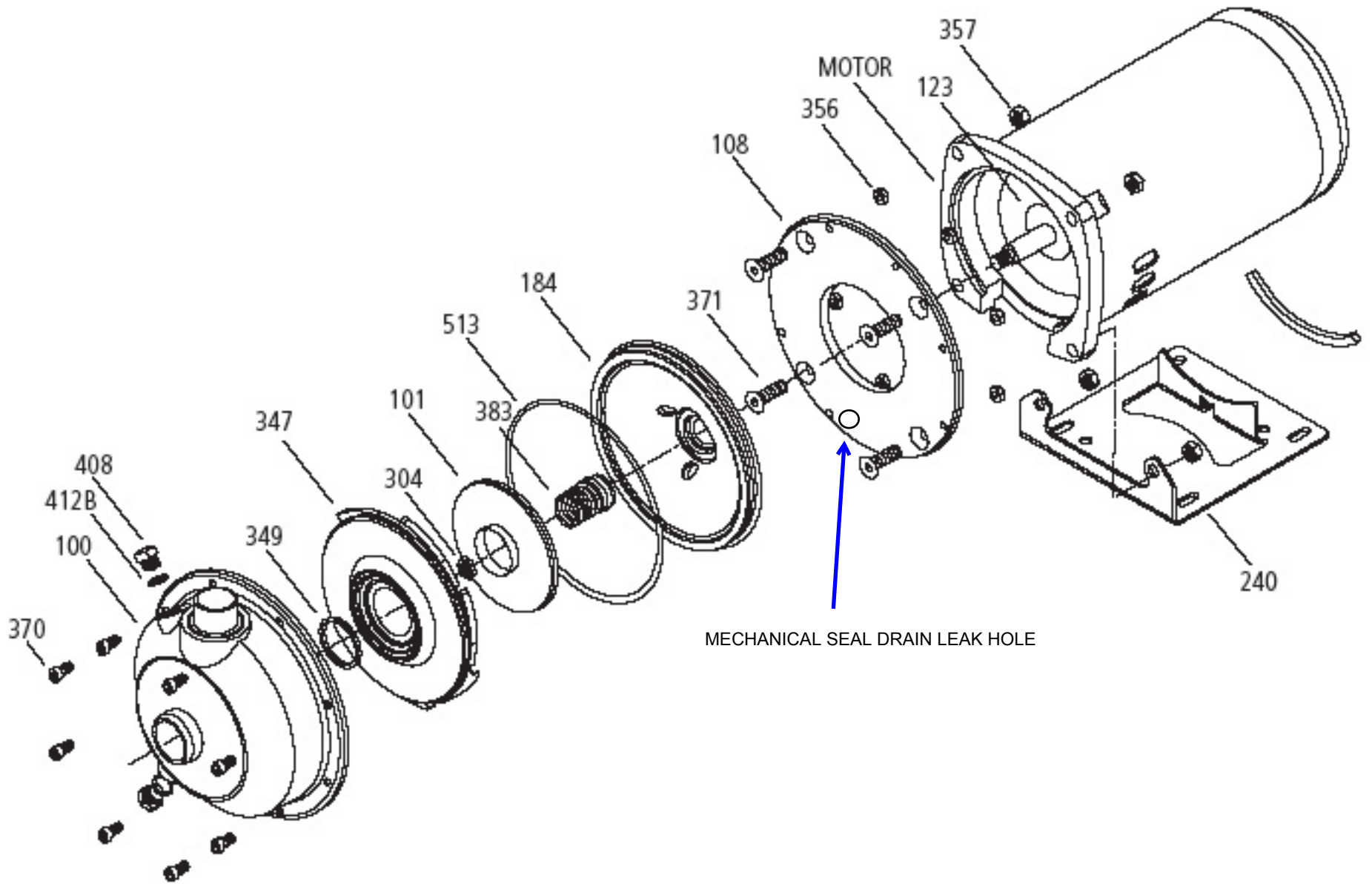

Get extended pump life...with G&L Packaged Seal Kits.

Replacing only a mechanical seal and not a badly worn or scarred shaft sleeve, or a damaged or old O-ring, frequently can cause premature failure of the newly replaced parts.

Our new G&L Seal Replacement kit for end suction pumps provides a complete set of recommended rotating parts and O-rings to insure maximum pump life.



DRAKE PART # D36-007

RPKNPE/MCS-DR

G&L SEAL REPAIR KIT

ITEM #	PART #	DESCRIPTION	MATERIAL	SIZE
383	10K55	MECHANICAL SEAL	CARBON /SC/ VITON	ALL
349	5K269	IMPELLER O-RING	VITON	1ST/1MS
349	5K270	IMPELLER O-RING	VITON	2,3ST/2,3MCS
513	5K206	CASING O-RING	VITON	ALL

NOTE: For use with G&L Pump Models NPE & MCS
For Drake Refrigeration

1ST/1MS = 1 x 1.25 - 6
2ST/2MS = 1.25 x 1.5 - 6
3ST/3MS = 1.5 x 2 - 6